

DORCAS



Electric

Strikes

TABLE OF CONTENTS

INTRODUCTION	3
N-SX	4
N-FLEX	5
412-SX	6
412-FLEX	7
AA-SX	8
AA-FLEX	8
AADS-FLEX	10
ND-SX	11
N524 -SX	12
N512-SX	13
N46	14
N46Aa	15
N46-412	16
N46-424	17
N46-512	18
305-412	18
N45	20
N201-SC	21
N201-CP	22
N201-PB	23
N205-CP	24
N205-SC	25
N205-PB	26
G/L-PLATES	27
J-SERIES ELECTRIC LOCKS	28
POWER TRANSFER DEVICES	29

Introduction

Dorcas Strike Company was established back in 1972 it is located in Valencia SPAIN, and since it was established it progressively built a reputation as one of the leading electric strike manufacturer in Europe.

The Dorcas strikes were first released in Australia back in 1976 and progressively become one of the most popular strikes in their class. The product was economically priced and was a choice by many Locksmiths, Intercom installers and access control industry for well over the past 30 years.

All Dorcas strikes are manufactured to the highest manufacturing standards, they comply to the **ISO9000**, the stringent German **TVU** standard and the European **CE** standards.

All the (DORCAS) branded models available in Australia are fitted with a extra low current **30Ω** solenoid coils that only draw **350mA** on power-up. Instead of the traditional coils found in similar priced brands that use **11Ω** coils, these strikes can draw well over 1100 mA of on power-up.

The NEW Dorcas "**Aa**" Automatic strikes just released have been well received by the security industry. The **Aa** models no longer deploy traditional spring-loaded PIN found in the earlier Automatic models and in other brands. The spring loaded PIN design has often caused locks to jam when the latch locks past the Automatic PIN. This can renders the strike inoperative. The new Dorcas "**Aa**" Automatic models no longer require a spring loaded PIN to provide the same function, therefore solving the age old problem of the locks jamming behind the PIN.

Specifications on all the new Automatic strikes are found on pages 6, 7, 8 and 14.

The traditional **N201 & N205** surface mount models are available in three different ecstastically pleasing colours and have set a bench mark for the surface mount strike design. They have become popular for home entry doors as well as external gates. With the choice of three colour finishes. These finishes make Dorcas surface strikes a preferred option by many installers.

All of the surface mount models are also available with **Aa** Automatic function as an option. The mechanism of the surface model can easily be changed to the mechanism function required for the application.

All the "**N**" series strikes come with non-rusting **Stainless Steel** face plates that makes them ideal for both indoor and outdoor applications.

All the Dorcas Strikes carry a 5 Year Manufacturers WARRANTY





Colours available



Brushed Stainless Steel

Model: N-SX

Part No: DOR100

Function

Standard Model

On activation of the strike releases the door and will unlock when power is applied, it will remain unlocked until the power is removed. (power to open)

Features

- Solid stainless steel face plate as standard
- Narrow style face plates, will fit most door frames
- Operates on, 12v DC, or 12-16v AC,
- Current draw 350mA, 12v DC or 12-16vAC
- Ideal for, Intercoms or Access Control applications
- Latch & Bolt face plates available
- Strong durable construction
- Built to ISO9227 standards
- ECONOMICALLY priced
- 5 Year Manufacturers Warranty



C-Tick Certified



CE Approved



TUV Approved



5 Year Warranty

Part No: DOR100		Specifications
Operation features:		STANDARD Power to Open
Style:		Narrow style Stainless Steel Face plate, flush mount strike
Operational voltage:		12v DC or 12-16v AC
Current draw:		350mA
Coil type:		30Ω coil
Colour:		Brushed stainless steel
Dimensions:		W25mm x H160mm x D28mm
Latch opening with		40mm
Warranty:		5 Years Manufactures Warranty
Models	Part No	Available Models
N-SX	DOR100	Standard model, Power to Open, 12v DC momentary operation coil, 350mA
N412	DOR135	Continuous Coil model, Power to Open, 12v DC, continuous coil, 125mA
N512	DOR130	Continuous Coil model, Power to Lock, 12v DC, continuous coil, 125mA



Colours available



Brushed Stainless Steel

Model: N-FLEX Part No: DOR105

Function

Standard Model with Adjustable Jaw

On activation of the strike releases the door and will unlock when power is applied, it will remain unlocked until the power is removed. (power to open)

Features

- Standard model with Adjustable Jaw
- Solid stainless steel face plate as standard
- Narrow style face plates, will fit most door frames
- Operates on, 12v DC, or 12-16v AC,
- Current draw 350mA, 12v DC or 12-16vAC
- Ideal for, Intercoms or Access Control applications
- Latch & Bolt face plates available
- Strong durable construction
- Built to ISO9227 standards
- ECONOMICALLY priced
- 5 Year Manufacturers Warranty



C-Tick Certified



CE Approved



TUV Approved



5 Year Warranty

Part No: DOR105		Specifications
Operation features:		STANDARD with adjustable jaw, power to open
Style:		Narrow style Stainless Steel Face plate, flush mount strike
Operational voltage:		12v DC or 12-16v AC
Current draw:		350mA
Coil type:		30Ω coil
Colour:		Brushed stainless steel
Dimensions:		W25mm x H160mm x D28mm
Latch opening with		40mm
Warranty:		5 Years Manufactures Warranty
Models	Part No	Available Models
N-SX	DOR100	Standard model, Power to Open, 12v DC momentary operation coil, 350mA
N412-SX	DOR135	Continuous Coil model, Power to Open, 12v DC, continuous coil, 125mA
N512-SX	DOR130	Continuous Coil model, Power to Lock, 12v DC, continuous coil, 125mA



Colours available



Brushed Stainless Steel

Model: N412-SX
Part No: DOR135

Function

Continuously rated coil model

On activation of the strike releases the door and will unlock when power is applied, it will remain unlocked until the power is removed. (power to open)

Features

- Solid stainless steel face plate as standard
- Narrow style face plates, will fit most door frames
- Operates on, 12v DC, Continuously rated coil
- Current draw 125mA, 12v DC or 12-16vAC
- Ideal for, Intercoms or Access Control applications
- Latch & Bolt face plates available
- Strong durable construction
- Built to ISO9227 standards
- ECONOMICALLY priced
- 5 Year Manufacturers Warranty

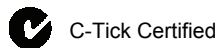

C-Tick Certified



CE Approved



TUV Approved

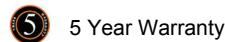

5 Year Warranty

Part No: DOR135		Specifications
Operation features:		STANDARD Power to Open
Style:		Narrow style Stainless Steel Face plate, flush mount strike
Operational voltage:		12v DC with Continuously rated coil
Current draw:		125mA
Coil type:		60Ω coil
Colour:		Brushed stainless steel
Dimensions:		W25mm x H160mm x D28mm
Latch opening with		40mm
Warranty:		5 Years Manufactures Warranty
Models	Part No	Available Models
N-SX	DOR100	Standard model, Power to Open, 12v DC momentary operation coil, 350mA
N412-SX	DOR135	Continuous Coil model, Power to Open, 12v DC, continuous coil, 125mA
N512-SX	DOR130	Continuous Coil model, Power to Lock, 12v DC, continuous coil, 125mA



Colours available



Brushed Stainless Steel

Model: N412-FLEX

Part No: DOR132

Features

Continuous Power Rated Coil with Adjustable Jaw

On applying power the strike will unlock, the strike will remain unlocked until the power is removed. The adjustable Jaw provides in-out door Adjustment where required. The model is a low current draw version that draws 125mA on 12vDC.

Features

- Automatic with adjustable Jaw
- Narrow style face plates, will fit most door frames
- Operates on 12v DC, 12-16v AC, or optional 24v
- Low current 60Ω COIL as standard, 12v DC, 350mA
- Ideal for, Access Control and Intercoms applications
- Mortise lock plates with Latch-Bolt are available
- Strong durable construction
- Quality product built to ISO9227 standards
- 5 Year Manufacturers Warranty



C-Tick Certified



CE Approved



TVU Approved



5 Year Warranty

Part No: DOR132		Specifications
Operation features:		Continuous Rated coil with Adjustable jaw
Style:		Narrow style Stainless Steel face plate, flush mount
Operational voltage:		12v DC or 12-16v AC
Current draw:		125mA DC on all continuous coil models
Coil type:		60Ω low current coil
Dimensions:		Face plate 25mm x 160mm, Depth 28mm
Latch opening with		40mm
Warranty:		5 Years Manufactures Warranty
Models	Part No	Available Models
N412-FLEX	DOR132	Continuous, Adjustable, Power to Open, 12v DC 125mA
N412-SX	DOR135	Continuous Coil model, Power to Open, 12v DC, continuous coil, 125mA
N512-SX	DOR130	Continuous Coil model, Power to Lock, 12v DC, continuous coil, 125mA



Colours available



Brushed Stainless Steel

Model: Aa/SX
Part No: DOR110

Function

Automatic Function

On activation the strike will release. The door will remain unlocked until it is opened and closed on access. The strike mechanism will automatically relock when door is closed after access.

Features

- Automatic function without the traditional PIN
- Solid stainless steel face plate as standard
- Narrow style face plates, will fit most door frames
- Operates on, 12v DC, or 12-16v AC,
- Current draw 350mA, 12v DC or 12-16vAC
- Ideal for, Intercoms or Access Control applications
- Latch & Bolt face plates available
- Strong durable construction
- Built to ISO9227 standards
- ECONOMICALLY priced
- 5 Year Manufacturers Warranty



C-Tick Certified



CE Approved



TUV Approved



5 Year Warranty

Part No: DOR110		Specifications
Operation features:		Automatic function, without the traditional PIN
Style:		Narrow style Stainless Steel Face plate, flush mount strike
Operational voltage:		12v DC, or 12-16v AC
Current draw:		350mA
Coil type:		30Ω coil
Colour:		Brushed stainless steel face plate
Dimensions:		W25mm x H160mm x D28mm
Latch opening with		40mm
Warranty:		5 Years Manufactures Warranty
Models	Part No	Available Models
Aa/SX	DOR110	Automatic function, without the traditional PIN
Aa-FLEX	DOR119	Automatic with adjustable Jaw
AaDS-SX	DOR121	Automatic, Adjustable Jaw with Mechanical Release lever



Colours available



Brushed Stainless Steel

Model: Aa-FLEX Part No: DOR119

Features

Automatic Feature with Adjustable Jaw

On activation the strike will release. The door will remain unlocked until it is opened and closed on access. The strike mechanism will automatically relock when door is closed after access.

Features

- Automatic with adjustable Jaw
- Narrow style face plates, will fit most door frames
- Operates on 12v DC, 12-16v AC, or optional 24v
- Low current 33Ω COIL as standard, 12v DC, 350mA
- Ideal for, Access Control and Intercoms applications
- Mortise lock plates with Latch-Bolt are available
- Strong durable construction
- Quality product built to ISO9227 standards
- 5 Year Manufacturers Warranty



C-Tick Certified



CE Approved



TUV Approved



5 Year Warranty

Part No: DOR119		Specifications
Operation features:	AUTOMATIC with adjustable jaw	
Style:	Narrow style Stainless Steel Face plate, flush mount strike	
Operational voltage:	12v DC or 12-16v AC	
Current draw:	350mA	
Coil type:	30Ω coil	
Colour:	Brushed stainless steel	
Dimensions:	W25mm x H160mm x D28mm	
Latch opening with	40mm	
Warranty:	5 Years Manufactures Warranty	
Models	Part No	Available Models
Aa-SX	DOR110	Automatic model, Power to Open, 12v 30Ω coil, 350mA
Aa-FLEX	DOR119	Automatic model with Adjustable jaw, Power to open, 12v 33Ω coil, 350mA



Model: AaDS-FLEX
Part No: DOR121

Function

Automatic, Adjustable, with Mechanical Release

On activation the strike will release. The door will remain unlocked until it is opened and closed on access. The strike mechanism will automatically relock when door is closed after access.

The adjustable jaw feature provides in-out door latch adjustment if required. This model comes with a mechanical release lever.

Features

- Automatic, Adjustable jaw, and Mechanical release
- This model comes with most of the popular functions
- Operates on, 12v DC, or 12-16v AC,
- Current draw 350mA, 12v DC or 12-16vAC
- Ideal for, Intercoms or Access Control applications
- Latch & Bolt face plates available
- Strong durable construction
- Built to ISO9227 standards
- ECONOMICALLY priced
- 5 Year Manufacturers Warranty

Colours available



Brushed Stainless Steel



C-Tick Certified



CE Approved



TVU Approved



5 Year Warranty

Part No: DOR121		Specifications
Operation features:		Automatic with Adjustable Jaw and Mechanical release lever
Style:		Narrow style Stainless Steel Face plate, flush mount strike
Operational voltage:		12v DC, or 12-16v AC
Current draw:		350mA
Coil type:		30Ω coil
Colour:		Brushed stainless steel face plate
Dimensions:		W25mm x H160mm x D28mm
Latch opening with		40mm
Warranty:		5 Years Manufactures Warranty
Models	Part No	Available Models
AaDS-SX	DOR121	Automatic, Adjustable Jaw with and Mechanical Release lever
ND-SX	DOR120	Standard model with Mechanical Release lever



Model: ND-SX
Part No: DOR120

Function

Standard with Mechanical Release

On activation of the strike releases the door and will unlock when power is applied, it will remain unlocked until the power is removed. (power to open)

This model comes with a mechanical release lever provided to have the door temporarily open.

Features

- Standard with Mechanical Release Lever
- Operates on, 12v DC, or 12-16v AC,
- Current draw 350mA, 12v DC or 12-16vAC
- Ideal for, Intercoms or Access Control applications
- Latch & Bolt face plates available
- Strong durable construction
- Built to ISO9227 standards
- ECONOMICALLY priced
- 5 Year Manufacturers Warranty

Colours available



Brushed Stainless Steel



C-Tick Certified



CE Approved



TVU Approved



5 Year Warranty

Part No: DOR120		Specifications
Operation features:		Standard with Mechanical release lever
Style:		Narrow style Stainless Steel Face plate, flush mount strike
Operational voltage:		12v DC, or 12-16v AC
Current draw:		350mA
Coil type:		30Ω coil
Colour:		Brushed stainless steel face plate
Dimensions:		W25mm x H160mm x D28mm
Latch opening with		40mm
Warranty:		5 Years Manufactures Warranty
Models	Part No	Available Models
AaDS-SX	DOR121	Automatic, Adjustable Jaw with Mechanical Release lever
ND-SX	DOR120	Standard model with Mechanical Release lever



Model: 524-SX
Part No: DOR140

Features

Power to lock 24v DC

On withdrawing 24v DC power the strike will unlock, the strike will remain unlocked until the power is reapplied.

Features

- Power to Lock model
- Operates on 24v DC
- Low Current draw, 125mA
- Narrow style face plates, will fit most door frames
- Ideal for, Intercoms or Access Control applications
- Latch & Bolt face plates available
- Strong durable construction
- Built to ISO9227 standards
- ECONOMICALLY priced
- 5 Year Manufacturers Warranty

Colours available



Brushed Stainless Steel



C-Tick Certified



CE Approved



TUV Approved



5 Year Warranty

Part No: DOR140		Specifications
Operation features		Power to Lock version
Style		Narrow style Brushed Stainless Steel Face plate, flush mount strike
Operational voltage		24v DC or
Current draw		125mA DC on all continuous coil models
Coil type		75Ω low current coil
Dimensions		W 25mm x H 160mm x D 25mm,
Latch opening with		40mm
Warranty		5 Years Manufactures Warranty
Models	Part No	Available Models
N524-SX	DOR140	Continuous Coil model, Power to Lock, 24v DC, continuous coil, 125mA
N424-SX	DOR136	Continuous Coil model, Power to Open, 24v DC, continuous coil, 125mA
N512-SX	DOR130	Continuous Coil model, Power to Lock, 12v DC, continuous coil, 125mA
N412-SX	DOR135	Continuous Coil model, Power to Open, 12v DC, continuous coil, 125mA



Model: N512-SX
Part No: DOR130

Function

Power to lock, 12v DC

Power to Lock strike. The strike will lock when power is applied and will open when power is removed.

Features

- Power to LOCK
- Operates on 12v DC
- Low Current draw at 125mA DC
- Narrow style face plates, will fit most door frames
- Ideal for, Intercoms or Access Control applications
- Latch & Bolt G/L face plates available
- Strong durable construction
- Built to ISO9227 standards
- ECONOMICALLY priced
- 5 Year Manufacturers Warranty

Colours available



Brushed Stainless Steel

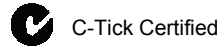

C-Tick Certified



CE Approved



TVU Approved

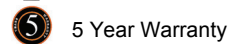

5 Year Warranty

Part No: DOR130		Specifications
Operation features		Power to Lock
Style		Narrow style Stainless Steel Face plate, flush mount strike
Operational voltage		12v DC
Current draw		125mA DC on all continuous coil models
Coil type		75Ω low current coil
Dimensions		W 25mm x H 160mm x D 28mm
Latch opening with		40mm
Warranty		5 Years Manufactures Warranty
Models	Part No	Available Models
N512-SX	DOR130	Continuous Coil model, Power to Lock, 12v DC, continuous coil, 125mA
N412-SX	DOR135	Continuous Coil model, Power to Open, 12v DC, continuous coil, 125mA



Colours available



Silver Grey Powder Coated

Model: N46
Part No: DOR112

Function

Standard with Latch Guide

Power to open. On application the strike will release and will relock when power is removed.

Features

- Powder coated face plate with Latch Guide
- Narrow style face plates, will fit most door frames
- Operates on, 12v DC, or 12-16v AC,
- Low current draw 30Ω Coil as standard, 12v DC, 350mA
- Ideal for, Access Control and Intercoms systems
- Mortise lock style silver grey colour
- Strong durable construction
- Quality product built to ISO9227 standards
- ECONOMICALLY priced
- 5 Year Manufacturers Warranty



C-Tick Certified



CE Approved



TVU Approved



5 Year Warranty

Part No: DOR112		Specifications
Operation features		Standard with latch guide
Operational voltage		12v DC or 12-16v AC
Current draw		350mA
Coil type		30Ω
Operation features		Standard momentary operation
Colour		Powder coated silver grey colour
Dimensions		W 28mm x H 149mm x D 35mm
Latch opening with		30mm
Warranty		5 Years Manufactures Warranty
Models	Part No	Available Models
N46-Aa	DOR113	Automatic, Power to Open, 12v DC
N46-412	DOR114	Continuous Coil, Power to Open, with 12v DC, 110mA
N46-424	DOR115	Continuous Coil model, Power to Lock with 24v DC, 110mA
N46-512	DOR116	Power to Lock with 12v DC, 110mA



Colours available



Silver Powder Coated

Model: N46-Aa
Part No: DOR113

Function

Automatic with Latch Guide

On activation the strike will release, the door will remain unlocked until it is opened and closed on access. The strike mechanism will automatically relocks when door is closed after access.

Features

- AUTOMATIC with Latch Guide
- Narrow style face plates, will fit most door frames
- Operates on, 12v DC, or 12-16v AC,
- Low current draw 30Ω Coil as standard, 12v DC, 350mA
- Ideal for, Access Control and Intercoms systems
- Mortise lock style silver grey colour
- Quality product built to ISO9227 standards
- ECONOMICALLY priced
- 5 Year Manufacturers Warranty

-  C-Tick Certified
-  CE Approved
-  TUV Approved
-  5 Year Warranty

Part No: DOR113		Specifications
Operation features		Automatic, without traditional PIN and latch guide
Operational voltage		12v DC or 12-16v AC
Current draw		350mA
Coil type		30Ω
Operation features		Standard momentary operation
Colour		Powder coated silver grey colour
Dimensions		W 28mm x H 149mm x D 35mm
Latch opening with		30mm
Warranty		5 Years Manufactures Warranty
Models	Part No	Available Models
N46	DOR112	Standard Coil, Power to Open, with 12v DC
N46-412	DOR114	Continuous Coil, Power to Open, with 12v DC, 110mA
N46-424	DOR115	Continuous Coil model, Power to Lock with 24v DC, 110mA
N46-512	DOR116	Continuous Coil model, Power to Lock with 12v DC, 110mA



Colours available



Silver Grey Powder Coated

Model: N46-412
Part No: DOR114

Function

Continuously Rated with Latch Guide

Power to open. On application the strike will release and will relock when power is removed.

Features

- Powder coated face plate with Latch Guide
- Narrow style face plates, will fit most door frames
- Operates on, 12v DC, or 12-16v AC,
- Low current draw 60Ω Coil as standard, 12v DC, 110mA
- Ideal for, Access Control and Intercoms systems
- Mortise lock style silver grey colour
- Strong durable construction
- Quality product built to ISO9227 standards
- ECONOMICALLY priced
- 5 Year Manufacturers Warranty



C-Tick Certified



CE Approved



TVU Approved



5 Year Warranty

Part No: DOR114		Specifications
Operation features		Standard with latch guide
Operational voltage		12v DC or 12-16v AC
Current draw		110mA
Coil type		60Ω
Operation features		Standard momentary operation
Colour		Powder coated silver grey colour
Dimensions		W 28mm x H 149mm x D 35mm
Latch opening with		30mm
Warranty		5 Years Manufactures Warranty
Models	Part No	Available Models
N46-Aa	DOR113	Automatic, Power to Open, 12v DC
N46-412	DOR114	Continuous Coil, Power to Open, with 12v DC, 110mA
N46-424	DOR115	Continuous Coil model, Power to Lock with 24v DC, 110mA
N46-512	DOR116	Power to Lock with 12v DC, 110mA



Colours available



Silver Grey Powder Coated

Model: N46-424
Part No: DOR115

Function

24v Continuously Rated with Latch Guide

Power to open. On application the strike will release and will relock when power is removed.

Features

- Powder coated face plate with Latch Guide
- Narrow style face plates, will fit most door frames
- Operates on, 24v DC
- Low current draw 60Ω Coil as standard, 24v DC, 110mA
- Ideal for, Access Control and Intercoms systems
- Mortise lock style silver grey colour
- Strong durable construction
- Quality product built to ISO9227 standards
- ECONOMICALLY priced
- 5 Year Manufacturers Warranty

-  C-Tick Certified
-  CE Approved
-  TUV Approved
-  5 Year Warranty

Part No: DOR115		Specifications
Operation features	24v Continuously Rated with latch guide	
Operational voltage	24v DC	
Current draw	110mA	
Coil type	60Ω	
Operation features	Standard momentary operation	
Colour	Powder coated silver grey colour	
Dimensions	W 28mm x H 149mm x D 35mm	
Latch opening with	30mm	
Warranty	5 Years Manufactures Warranty	
Models	Part No	Available Models
N46-Aa	DOR113	Automatic, Power to Open, 12v DC
N46-412	DOR114	Continuous Coil, Power to Open, with 12v DC, 110mA
N46-424	DOR115	Continuous Coil model, Power to Lock with 24v DC, 110mA
N46-512	DOR116	Power to Lock with 12v DC, 110mA



Colours available



Silver Grey Powder Coated

Model: N46-512
Part No: DOR116

Function

12v Power to Lock with Latch Guide

Power to lock. On application the strike will lock and will relock when power is applied.

Features

- Powder coated face plate with Latch Guide
- Narrow style face plates, will fit most door frames
- Operates on, 12v DC with Power to LOCK function
- Low current draw 60Ω Coil as standard, 12v DC, 110mA
- Ideal for, Access Control and Intercoms systems
- Mortise lock style silver grey colour
- Strong durable construction
- Quality product built to ISO9227 standards
- ECONOMICALLY priced
- 5 Year Manufacturers Warranty



C-Tick Certified



CE Approved



TUV Approved



5 Year Warranty

Part No: DOR116		Specifications
Operation features		12v Power to LOCK with latch guide
Operational voltage		24v DC
Current draw		110mA
Coil type		60Ω
Operation features		Standard momentary operation
Colour		Powder coated silver grey colour
Dimensions		W 28mm x H 149mm x D 35mm
Latch opening with		30mm
Warranty		5 Years Manufactures Warranty
Models	Part No	Available Models
N46-Aa	DOR113	Automatic, Power to Open, 12v DC
N46-412	DOR114	Continuous Coil, Power to Open, with 12v DC, 110mA
N46-424	DOR115	Continuous Coil model, Power to Lock with 24v DC, 110mA
N46-512	DOR116	Power to Lock with 12v DC, 110mA



Model: N305-412 SX
Part No: DOR165

Function

Monitored Model

On activation of the strike will open, it will remain unlocked until the power is removed. Monitor switch output is provided.

Features

- Latch Monitoring switched output
- Narrow style face plates, will fit most door frames
- Operates on, 12v DC, or 12-16v AC,
- Current draw 110mA, 12v DC or 12-16vAC
- Ideal for, Intercoms or Access Control applications
- Latch & Bolt face plates available
- Strong durable construction
- Built to ISO9227 standards
- ECONOMICALLY priced
- 5 Year Manufacturers Warranty

Colours available



Brushed Stainless Steel

-  C-Tick Certified
-  CE Approved
-  TUV Approved
-  5 Year Warranty

Part No: DOR165		Specifications
Operational Features		MONITORED with continuously rated coil
Face Plate		Narrow style Stainless Steel Face plate, flush mount
Operational voltage		12v DC or 12-16v AC
Current draw		110mA
Coil type		75Ω
Dimensions		W25mm x H160mm x D28mm
Latch opening with		40mm
Warranty		5 Years Manufactures Warranty
Models	Part No	Available Models
N305-412SX	DOR165	Power to Open, 12v DC Continuously rated coil, 110mA
N305-512SX	DOR150	Power to Lock, 12v DC Continuously rated coil, 110mA



Colours available



Brushed Stainless Steel

Model: N45 Part No: DOR300

Function

On activation of the strike will release the door. (power to open) Strike will unlock when power is applied and will remain unlocked until the power is removed.

Key Features

- SYMMETRICAL Compact design
- Narrow style face plates, Brushed stainless steel
- Operates on, 12v DC, 12-16v AC,
- Low current 30Ω COIL as standard A
- Ideal for, Access Control and Intercoms applications
- Strong durable construction
- Quality product built to ISO9227 standards
- ECONOMICALLY priced
- 5 Year Manufacturers Warranty



C-Tick Certified



CE Approved



TVU Approved



5 Year Warranty

Part No: DOR300		Specifications
Operation features		Narrow style SYMETRICAL model
Operational voltage		12v DC or 12-16v AC
Current draw		350mA
Coil type		30Ω
Operation features		Standard momentary operation
Colour		Brushed Stainless Steel face plate
Dimensions		H123mm x W32mm x D40mm
Latch opening with		45mm
Warranty		5 Years Manufactures Warranty
Models	Part No	Available Models
N45	DOR300	Standard model, Power to open , 12v DC, 350mA
N45-A	DOR310	Automatic model, Power to open, 12v DC, 350mA
N45-412	DOR310	Continuous Coil model, Power to open, 12v DC, 110mA



Model: N201-SC
Part No: DOR190A

Function

On activation of the strike release the door (power to open) The strike will unlock when power is applied and will remain unlocked until the power is removed.

Features

- Surface mount type, face mount for easy installation
- Ideal for Gates and Doors where rim locks are used
- Low current 30Ω COIL as standard, 12v DC, 350mA
- Ideal for, Access Control and Intercoms applications
- Strong durable construction, Polished Brass Colour
- Quality product built to ISO9227 standards
- ECONOMICALLY priced
- 5 Year Manufacturers Warranty

Colours available



-  C-Tick Certified
-  CE Approved
-  TVU Approved
-  5 Year Warranty

Part No: DOR190A		Specifications
Type	Surface face mount design, Chrome Plated	
Operational voltage	12v DC, or 12-16v AC	
Current draw	360mA	
Coil type	30Ω coil	
Operation features	Standard momentary operation	
Colour	Satin Chrome Plated Colour	
Dimensions	H 146mm x W 36mm x D 25mm	
Warranty	5 Years Manufactures Warranty	
Models	Part No	Available Models
N201-CP	DOR190	Chrome Plated Standard model, Power to Open , 350mA
N201-SC	DOR190A	Satin Chrome Standard model, Power to Open, with 12v DC, 350mA
N202-PB	DOR200	Brass Colour Standard model, Power to Open, with 12v DC, 350mA



Model: N201-CP
Part No: DOR190

Function

On activation of the strike release the door (power to open) The strike will unlock when power is applied and will remain unlocked until the power is removed.

Features

- Surface mount type, face mount for easy installation
- Ideal for Gates and Doors where rim locks are used
- Low current 30Ω COIL as standard, 12v DC, 350mA
- Ideal for, Access Control and Intercoms applications
- Strong durable construction, Chrome Plated
- Quality product built to ISO9227 standards
- ECONOMICALLY priced
- 5 Year Manufacturers Warranty

-  C-Tick Certified
-  CE Approved
-  TVU Approved
-  5 Year Warranty

Colours available



PB



CP



SC

Part No: DOR190		Specifications
Type	Surface face mount design	
Operational voltage	12v DC, or 12-16v AC	
Current draw	360mA	
Coil type	30Ω coil	
Operation features	Standard momentary operation	
Colour	Chrome Plated	
Dimensions	H 146mm x W 36mm x D 25mm	
Warranty	5 Years Manufactures Warranty	
Models	Part No	Available Models
N201-CP	DOR190	Chrome Plated Standard model, Power to Open , 350mA
N201-SC	DOR190A	Satin Chrome Standard model, Power to Open, with 12v DC, 350mA
N202-PB	DOR200	Brass Colour Standard model, Power to Open, with 12v DC, 350mA



Model: N202-PB
Part No: DOR200

Function

On activation of the strike release the door (power to open) The strike will unlock when power is applied and will remain unlocked until the power is removed.

Features

- Surface mount type, face mount for easy installation
- Ideal for Gates and Doors where rim locks are used
- Low current 33Ω COIL as standard, 12v DC, 350mA
- Ideal for, Access Control and Intercoms applications
- Strong durable construction, Polished Brass Colour
- Quality product built to ISO9227 standards
- ECONOMICALLY priced
- 5 Year Manufacturers Warranty

-  C-Tick Certified
-  CE Approved
-  TUV Approved
-  5 Year Warranty

Colours available



PB

CP

SC

Part No: DOR200		Specifications
Type	Surface face mount design	
Operational voltage	12v DC, or 12-16v AC	
Current draw	360mA	
Coil type	30Ω coil	
Operation features	Standard momentary operation	
Colour	Polished Brass Colour	
Dimensions	H 146mm x W 36mm x D 25mm	
Warranty	5 Years Manufactures Warranty	
Models	Part No	Available Models
N201-CP	DOR190	Chrome Plated Standard model, Power to Open , 350mA
N201-SC	DOR190A	Satin Chrome Standard model, Power to Open, with 12v DC, 350mA
N202-PB	DOR200	Brass Colour Standard model, Power to Open, with 12v DC, 350mA



Model: N205-CP
Part No: DOR210

Function

On activation of the strike release the door (power to open) The strike will unlock when power is applied and will remain unlocked until the power is removed.

Features

- Surface mount type with concealed fixing screws
- Satin Chrome Colour Model (CP) Chrome Plated
- Ideal for Gates and Doors where rim locks are used
- Low current 33Ω COIL as standard, 12v DC, 350mA
- Ideal for, Access Control and Intercoms applications
- Strong durable construction, Satin Chrome Plated
- Quality product built to ISO9227 standards
- ECONOMICALLY priced
- 5 Year Manufacturers Warranty

 C-Tick Certified

 CE Approved

 TUV Approved

 5 Year Warranty

Colours available



PB



CP



SC

Part No: DOR210		Specifications
Type	Surface face mount design	
Operational voltage	12v DC, or 12-16v AC	
Current draw	360mA	
Coil type	30Ω coil	
Operation features	Standard momentary operation	
Colour	Satin Chrome Plated	
Dimensions	H 146mm x W 36mm x D 25mm	
Models	Part No	Available Models
N205-CP	DOR210	Chrome Plated Standard model, Power to Open , 350mA
N205-SC	DOR210A	Satin Chrome Plated Standard model, Power to Open, with 12v DC, 350mA
N205-PB	DOR215	Polished Brass Colour Standard model, Power to Open, with 12v DC, 350mA



Model: N205-SC
Part No: DOR210A

Function

On activation of the strike release the door (power to open) The strike will unlock when power is applied and will remain unlocked until the power is removed.

Features

- Surface mount type with concealed fixing screws
- Satin Chrome Colour Model (SPC)
- Ideal for Gates and Doors where rim locks are used
- Low current 33Ω COIL as standard, 12v DC, 350mA
- Ideal for, Access Control and Intercoms applications
- Strong durable construction, Satin Chrome Plated
- Quality product built to ISO9227 standards
- ECONOMICALLY priced
- 5 Year Manufacturers Warranty

 C-Tick Certified

 CE Approved

 TVU Approved

 5 Year Warranty

Colours available



PB



CP



SC

Part No: DOR210A		Specifications
Type	Surface face mount design	
Operational voltage	12v DC, or 12-16v AC	
Current draw	360mA	
Coil type	30Ω coil	
Operation features	Standard momentary operation	
Colour	Satin Chrome Plated	
Dimensions	H 146mm x W 36mm x D 25mm	
Models	Part No	Available Models
N205-CP	DOR210	Chrome Plated Standard model, Power to Open , 350mA
N205-SC	DOR210A	Satin Chrome Plated Standard model, Power to Open, with 12v DC, 350mA
N205-PB	DOR215	Polished Brass Colour Standard model, Power to Open, with 12v DC, 350mA



Model: N205-PB
Part No: DOR215

Function

On activation of the strike release the door (power to open) The strike will unlock when power is applied and will remain unlocked until the power is removed.

Features

- Surface mount type with concealed fixing screws
- Ideal for Gates and Doors where Rim locks are used
- Low current 33Ω COIL as standard, 12v DC, 350mA
- Ideal for, Access Control and Intercoms applications
- Strong durable construction, Polished Brass Colour
- Quality product built to ISO9227 standards
- ECONOMICALLY priced
- 5 Year Manufacturers Warranty

Colours available



- C-Tick Certified
- CE Approved
- TVU Approved
- 5 Year Warranty

Part No: DOR215		Specifications
Type	Surface face mount design, with concealed mounting screws	
Operational voltage	12v DC, or 12-16v AC	
Current draw	360mA	
Coil type	30Ω coil	
Operation features	Standard momentary operation	
Colour	Polished Brass Colour	
Dimensions	H 146mm x W 36mm x D 25mm	
Warranty	5 Years Manufactures Warranty	
Models	Part No	Available Models
N205-CP	DOR210	Chrome Plated Standard model, Power to Open , 350mA
N205-SC	DOR210A	Satin Chrome Standard model, Power to Open, with 12v DC, 350mA
N205-PB	DOR215	Brass Colour Standard model, Power to Open, with 12v DC, 350mA



G-Plate

G/L-Plates

Colours available



Brushed Stainless Steel

Model: G/L-PLATES

Part No: DOR230

Function

The G/L plates are designed to fit directly on to any DORCAS flush mount strike so the strike can be used with Deadbolt Mortise LOCKS that have a combination LATCH and deadbolt.

Features

- Solid Stainless Steel Construction
- Will suit most of the popular brand locks
- Available in two different styles G and L
- Strong durable construction
- Quality product built to ISO9227 standards
- ECONOMICALLY priced
- 5 Year Manufacturers Warranty



C-Tick Certified



CE Approved



TVU Approved



5 Year Warranty

Part No: DOR230		Specifications
Face plate size (G plate)		Brushed stainless steel face plate
Style		Suitable for Latch/Bolt mortice locks
Suitable for		All the DORCAS N series strikes
Warranty		5 Years Manufactures Warranty
Models	Part No	Available Models
G-Plate	DOR230	The G/L Plates are used when strike is installed with Latch/Bolt locks
L-Plate		The L Plates for Latch/Bolt locks with higher lock bolt slot position



Model: J Series
Part No: DOR520

Function

Key-Override Electric Mortise Lock

On activation of the strike releases the door will unlock when power is applied and will remain unlocked until power is removed. Cylinder provided for key override function. The lock has provision for egress lever handle.

DOR520 Features

- Electric Mortise Lock with key override and exit handles
- Secure deadbolt operation
- Available in 5 different back-sets, from 20 to 60mm
- Operating Voltage 12v DC, 35mA.
- Ideal for, Access Control and Intercoms applications
- Suitable for single or two-way swinging doors
- Quality product built to ISO9227 standards
- ECONOMICALLY priced
- 5 Year Manufacturers Warranty

Colours available



Brushed Stainless Steel



C-Tick Certified



CE Approved



TUV Approved



5 Year Warranty

Part No: DOR520		Specifications
Face plate		Brushed stainless steel
Style		20mm Back Set
Operational voltage		12v DC
Current draw		360mA
Operation features		Suitable for single or two-way swinging doors
Key override cylinder		Key override function
Exit handle		Provision for exit lever handle
Dimensions		LOCK dimensions L 85 x W 20mm. STRIKER dimensions
Warranty		5 Years Manufactures Warranty
Models	Part No	Available Models
J-20	DOR520	20mm Back set DORCAS J series Electric Mortise Lock
J-22	DOR522	22mm Backseat DORCAS J series Electric Mortise Lock
J-32	DOR532	32mm Back set DORCAS J series Electric Mortise Lock
J-50	DOR550	50mm Back set DORCAS J series Electric Mortise Lock
J-60	DOR560	60mm Backseat DORCAS J series Electric Mortise Lock

Power Transfer Devices

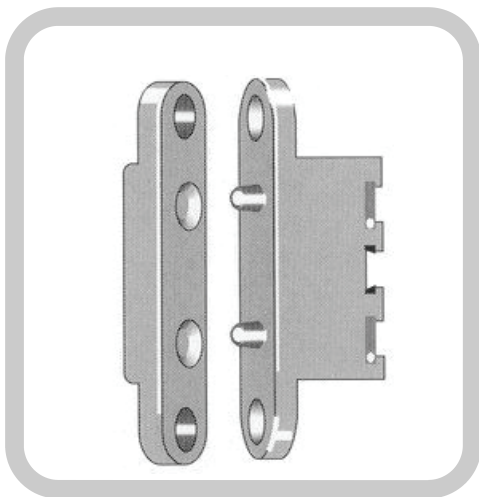

2-C (DOR220)

2-PIN Power transfer device ideal for Electric Mortice Locks fitted to the DOOR. The spring loaded PIN set can be fitted to transfer power from the hinge side of the frame to the door.



3-C (DOR221)

3-PIN Power transfer device ideal for Electric Mortice Locks. The 3-PIN set can be fitted to the hinge side of the door to transfer power to the door. The 3-PIN version is Ideal where both the power transfer and the lock bolt monitoring is also required.



2C-NEG (DOR222)

Wiping PINs 2-PIN power transfer ideal for Electric Mortise Locks. The wiping spring loaded PINs provide power transfer function to be fitted on to the Lock side of the door. The PIN set comes complete with series of mounting spacers suitable for both wooden or steel doorframes.



X1-300 & X1-600 (DOR240/245)

The tough Heavy duty Stainless Steel Armoured cord. The X-1 Cord is ideal for double doors, or Electric Locks that are fitted to single leaf doors or gates that require power transfer from the hinge side of the door. The cord comes complete with metal ends and mounting screws. Up to 6 core cable provision.

Models	Part No	Available Models
2-C	DOR220	2-PIN power transfer set
3-C	DOR221	3-PIN power transfer set
2-C-NEG	DOR222	2-PIN power transfer set with wiping contacts
X1-300	DOR240	300mm Stainless Steel Armoured door cord
X1-600	DOR245	600mm Stainless Steel Armoured door cord



Distributed By:-

VIC:

Mainline Security Products Pty Ltd

221 Nepean Hwy
Gardenvale, Vic 3185

Tel: (03) 9596 6688

Fax: (03) 9596 613

sales@mainline.com.au

ABN 60 006 595 044 VIC REG: 716-033-90S

QLD:

Mainline Security Products Pty Ltd

54 Caswell Street
East Brisbane Qld 4169

Tel: (07) 3891 2222

Fax: (07) 3891 7722

salesqld@mainline.com.au

ABN 60 006 595 044 QLD REG: 3246237

DORCAS
